

7 Penn Plaza

370 7th Avenue, New York, NY 10001



At 30th Street

Up to 3,454 SF Prime Corner Retail Space Available in Midtown

Ground Floor 1,822 SF

Lower Level 1,367 SF

Mezzanine 265 SF

- Former Sticky's Finger Joint space fully built-out as a quick service restaurant with black iron
- Steps from Madison Square Garden and Penn Station, the busiest train station serving 600,000 riders per day
- Area developments include Moynihan Station, Hudson Yards, MTA's East Side Access project (LIRR extension)
- Join building tenants Starbucks, Sweetgreen, Naya Express, and Smashburger



THE FEIL ORGANIZATION

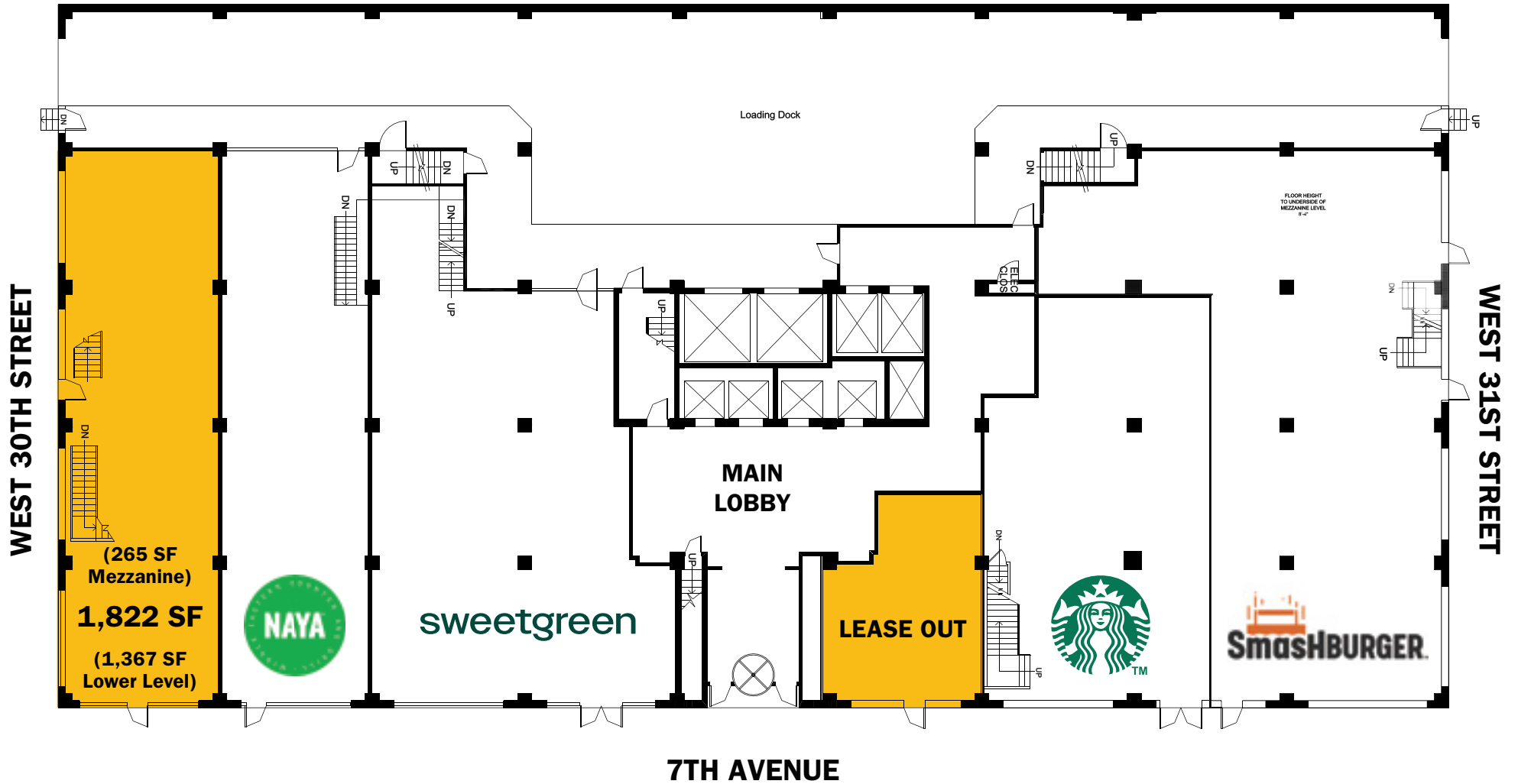

For leasing information, please contact Randall Briskin 212 609 8618 | rbriskin@feilorg.com or Nicholas Dries 212 609 8687 | ndries@feilorg.com

THE FEIL ORGANIZATION 7 Penn Plaza, New York, NY 10001 T 212 279 7600 www.feilorg.com