

# 7 Penn Plaza

370 7th Avenue, New York, NY 10001



**Between 30th and 31st Streets**

**Prime Retail Space Available in the Heart of Midtown**

**Ground Floor 650 SF**

**Frontage: 17' 5" on 7th Avenue**

**Lower Level 644 SF**

- Steps from Madison Square Garden and Penn Station, the busiest train station in North America which serves 650,000 riders per day
- New area developments include Moynihan Station, Hudson Yards, and the MTA's East Side Access project (LIRR extension)
- Join building tenants Starbucks, Sweetgreen, Sticky's Finger Joint, Naya Express, and our newest tenant Smashburger



THE FEIL ORGANIZATION

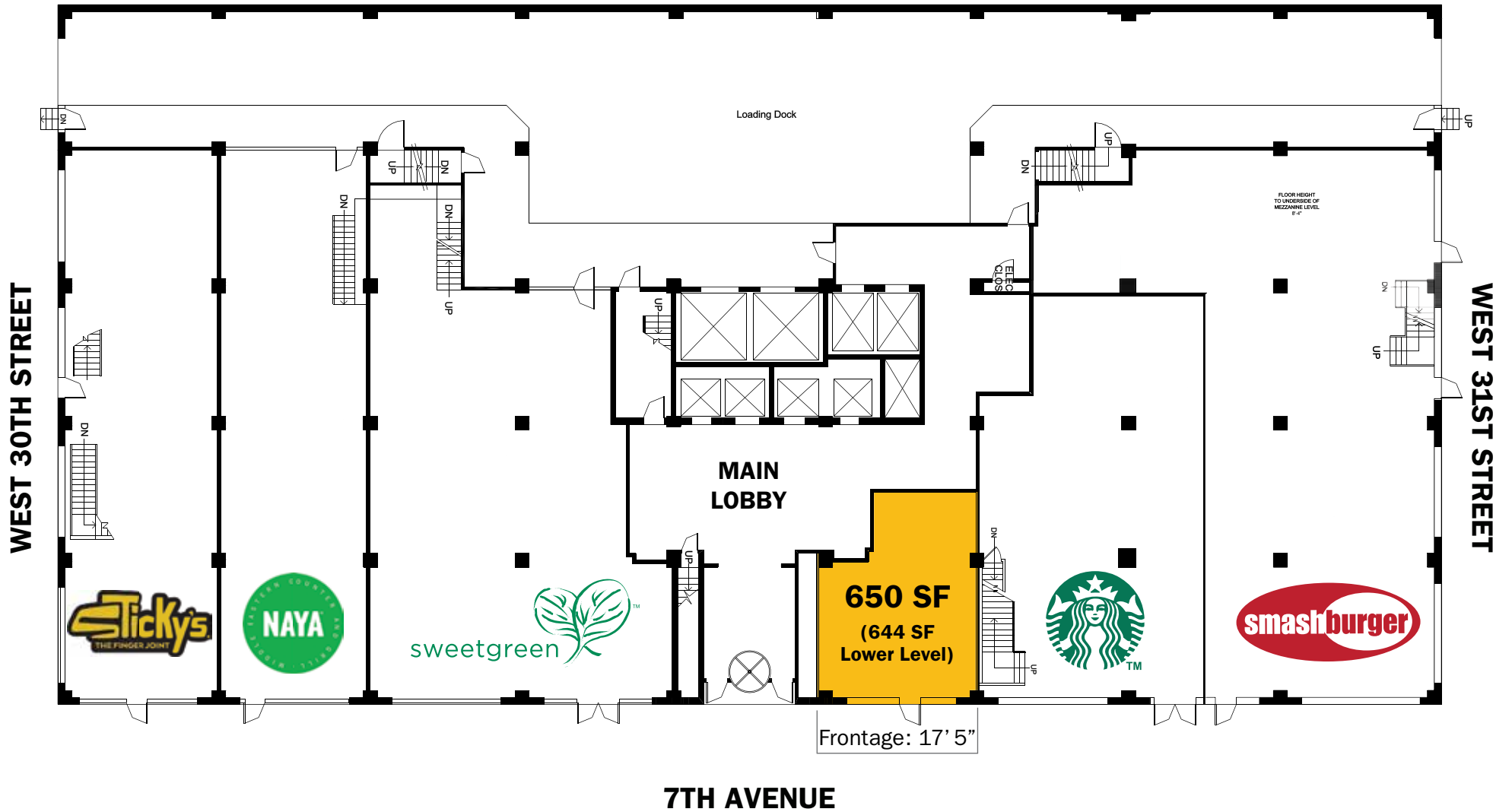

For leasing information, please contact Randall Briskin 212 609 8618 | rbriskin@feilorg.com or Nicholas Dries 212 609 8687 | ndries@feilorg.com

**THE FEIL ORGANIZATION** 7 Penn Plaza, New York, NY 10001 T 212 279 7600 www.feilorg.com